

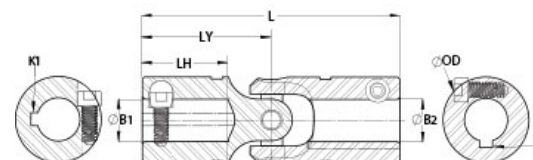

Brand	Ruland
Max Operating Angle	45
O.D. (D)	0.745 in
Bore (B1)	0.3750 in
Bore (B2)	0.3750 in
Keyway	Yes
Keyway (K1)	3/32 in
Keyway (K2)	3/32 in
B1 Max Shaft Penetration	0.950 in
B2 Max Shaft Penetration	0.950 in
Rated Torque	250 in-lb
Bore Tolerance	+0.0010 in / -0.0000 in
Joint Outer Diameter (OD)	0.745 in
Material	Alloy Steel
Hub Depth (LH)	0.950 in
Yoke Length (LY)	1.344 in
Screw Material	Alloy Steel with Nypatch
Screw Finish	Black Oxide
Forged Clamp Screw	M2.5
Recommended Lubricant	LUBRIPLATE No. 1200-2
Matching Boot Cover	UBOOT12/19-NI-KIT
ISO 9001:2015	Yes
REACH	Yes
RoHS3	Yes
Conflict Minerals	Compliant
Tariff Code	8483.60.4000
Product Group	Universal Joints - Clamp Style
Length (L)	2.688 in



COMPONENT	Single Universal Joint
-----------	------------------------



Pacific International Bearing, Inc.
33258 Central Ave, Union City, CA 94587
1-800-228-8895, 510-512-7000,
info@pibsales.com
www.pibsales.com

This file and any associated information and specifications are provided for reference and evaluation purposes only, and is subject to change without notice. PIB makes no representations, warranties or guarantees as to the appropriateness, accuracy, completeness, or suitability for any purpose, of the file, information or specifications. You are solely responsible for the use of the file, information or specifications.

USCLK12-6-6-F
Ruland
3/8" X 3/8" Single Universal Joint, 0.745" Od, 2.688"
Length, Friction Bearing, Steel, Clamp, Coupling

UNIT
Inch
SHEET