

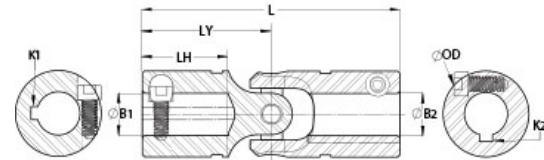

Brand	Ruland
Max Operating Angle	45
O.D. (D)	0.995 in
Bore (B1)	0.5000 in
Bore (B2)	0.5000 in
Keyway	Yes
Keyway (K1)	1/8 in
Keyway (K2)	1/8 in
B1 Max Shaft Penetration	1.190 in
B2 Max Shaft Penetration	1.190 in
Rated Torque	315 in-lb
Bore Tolerance	+0.0010 in / -0.0000 in
Joint Outer Diameter (OD)	0.995 in
Material	Stainless Steel
Hub Depth (LH)	1.190 in
Yoke Length (LY)	1.688 in
Screw Material	18-8 300 Series Stainless Steel with Nypatch
Screw Finish	Bright
Forged Clamp Screw	M4
Recommended Lubricant	LUBRIPLATE No. 1200-2
Matching Boot Cover	UBOOT16/25-NI-KIT
ISO 9001:2015	Yes
REACH	Yes
RoHS3	Yes
Conflict Minerals	Compliant
Tariff Code	8483.60.4000
Product Group	Universal Joints - Clamp Style
Length (L)	3.380 in



COMPONENT	Single Universal Joint
-----------	------------------------



Pacific International Bearing, Inc.
33258 Central Ave, Union City, CA 94587
1-800-228-8895, 510-512-7000,
info@pibsales.com
www.pibsales.com

This file and any associated information and specifications are provided for reference and evaluation purposes only, and is subject to change without notice. PIB makes no representations, warranties or guarantees as to the appropriateness, accuracy, completeness, or suitability for any purpose, of the file, information or specifications. You are solely responsible for the use of the file, information or specifications.

USCLK16-8-8-SS
Ruland
1/2" X 1/2" Single Universal Joint, 0.995" Od, 3.380"
Length, Friction Bearing, Steel, Clamp, Stainless
Steel, Clamp, Coupling

UNIT

Inch

SHEET